

**NOTE:** 300C CARRIERS ARE DIRECTIONAL, CHECK ORIENTATION PRIOR TO INSTALLATION

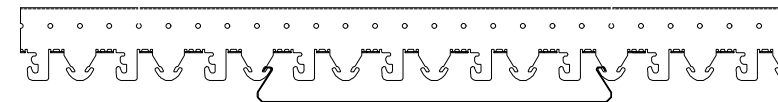

**SIDE VIEW OF 300C CARRIER WITH PANEL**

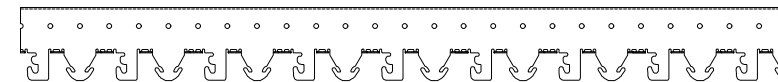

**SIDE VIEW OF 300C CARRIER**

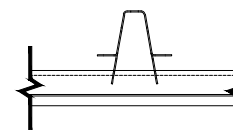

**END VIEW OF 300C CARRIER WITH PANEL**



**END VIEW OF 300C CARRIER**

**300C CARRIER**

**MATERIAL:** .040" ALUMINUM

**FINISH:** MATTE BLACK

**PART LENGTH:** 16'-0"

**SPECIFICATIONS**

(unless noted otherwise)

**MATERIAL:** .028" ALUMINUM 300C PANEL | .040" ALUMINUM 300C CARRIER

**FINISH:** PAINT | POWDER COAT | DECORATED WOOD FINISH | WOOD VENEER | LUXACOTE

**PERFORATION:** NON-PERFORATED | #160

**SUSPENSION SPEC**

**PROJECT:** 300C PRODUCT SPECIFICATIONS

**DRAWING NUMBER:** 300C-A1.2

**SCALE:** NTS

**DRAWN BY:** HDA ENGINEERING

**DATE:** 6/28/18