

**BOX SERIES DETAIL**  
SCALE: 3" = 1'-0"

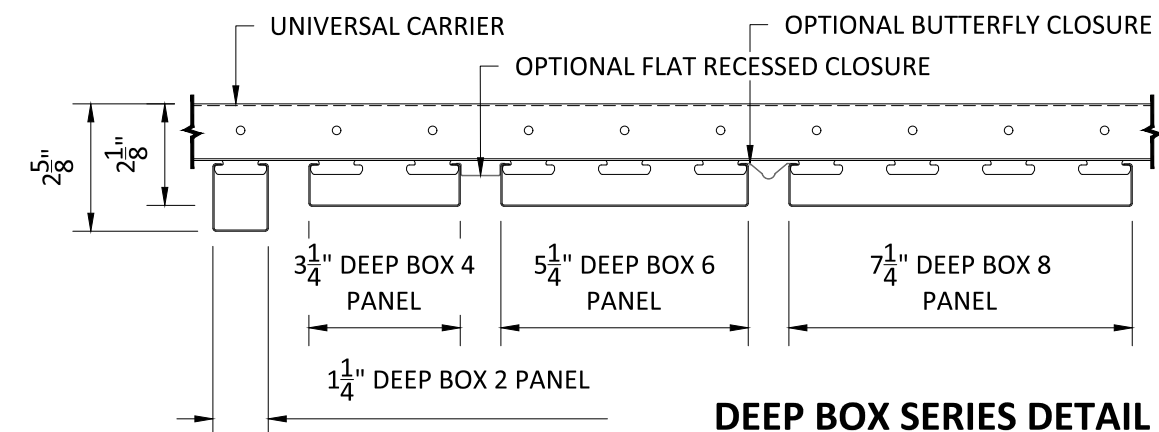

**DEEP BOX SERIES DETAIL**  
SCALE: 3" = 1'-0"

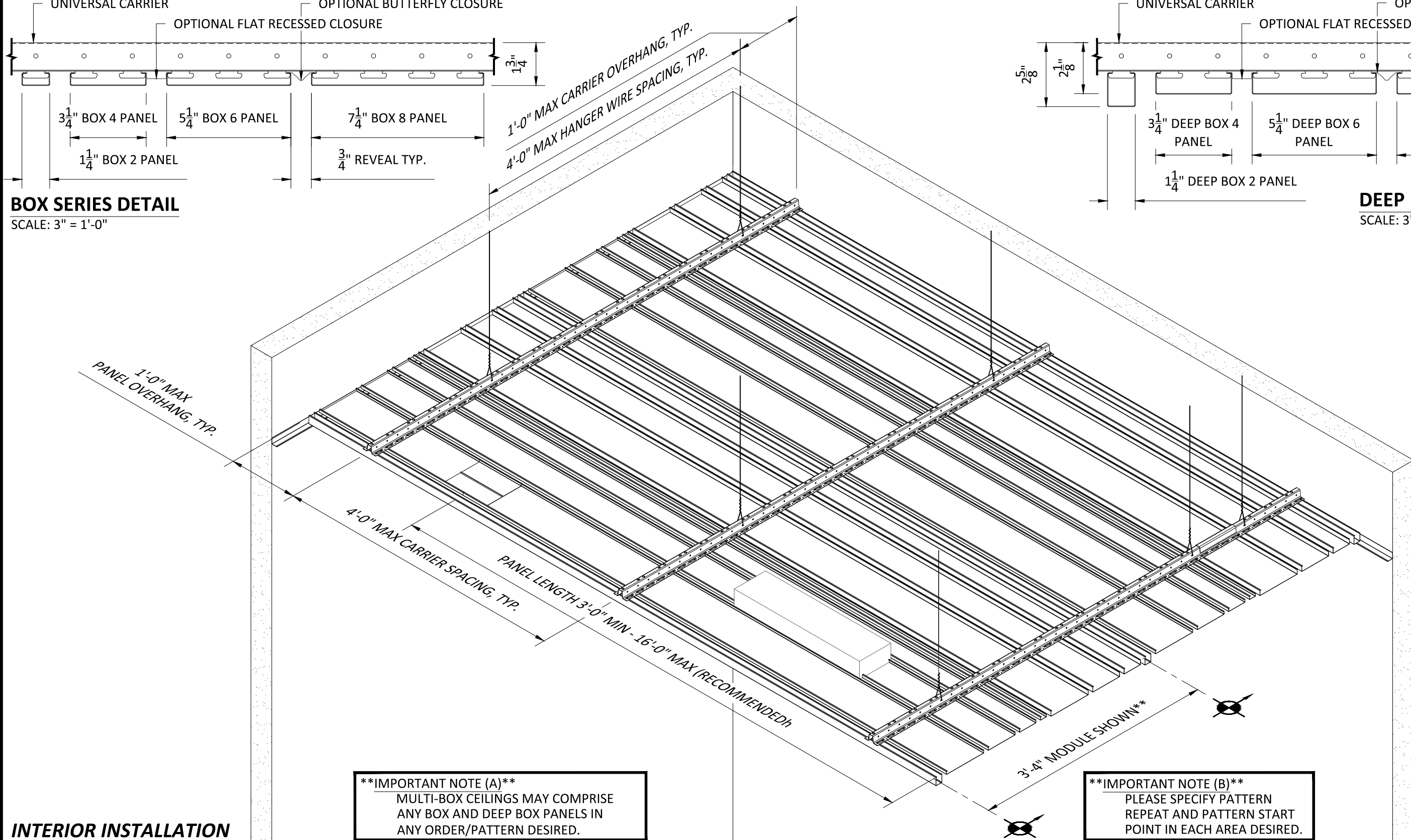

**\*\*IMPORTANT NOTE (A)\*\***  
MULTI-BOX CEILINGS MAY COMPRISE ANY BOX AND DEEP BOX PANELS IN ANY ORDER/PATTERN DESIRED.

**\*\*IMPORTANT NOTE (B)\*\***  
PLEASE SPECIFY PATTERN REPEAT AND PATTERN START POINT IN EACH AREA DESIRED.

**INTERIOR INSTALLATION**

**SPECIFICATIONS**  
(unless noted otherwise)

MATERIAL: SEE DETAIL A1.1 THIS SET FOR MULTI-BOX PANELS | .040" ALUMINUM  
UNIVERSAL CARRIER  
FINISH: PAINT | POWDER COAT | DECORATED WOOD FINISH | WOOD VENEER | LUXACOTE  
PERFORATION: SEE DETAIL A1.1 THIS SET

**OVERALL ISOMETRIC VIEW**

PROJECT: MULTI-BOX CONTINUOUS PRODUCT SPECIFICATIONS  
DRAWING NUMBER: MULTI-BOX CONT-A1.0  
SCALE: AS SHOWN  
DRAWN BY: HDA ENGINEERING  
DATE: 8/15/16

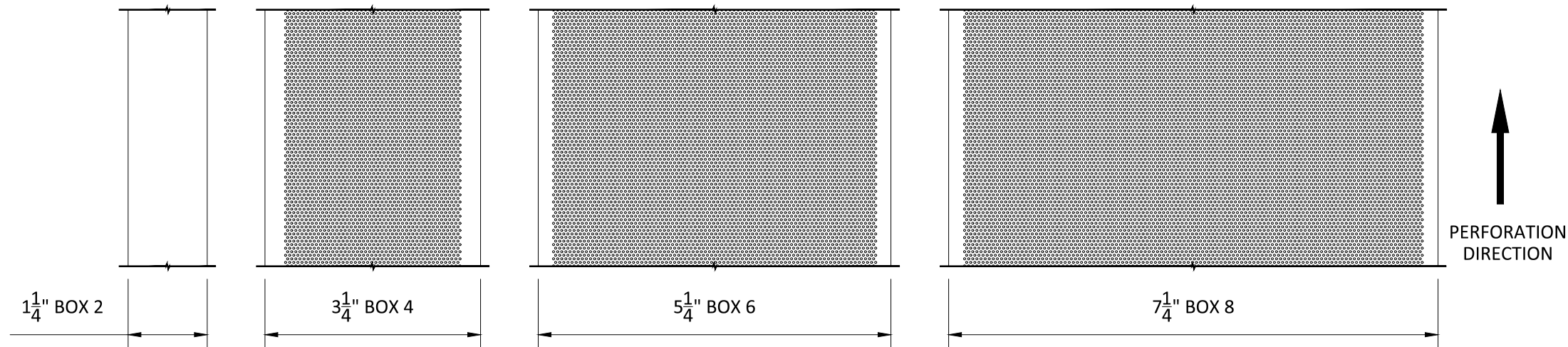

**PERFORATION #160 PATTERN**  
SCALE: 6" = 1'-0"

TABLE 1 - PERFORATION OPTIONS	
PANEL SIZE	PERFORATION
BOX 2	NONE AVAILABLE
DEEP BOX 2	NONE AVAILABLE
BOX 4	#160 (23% OPEN)
DEEP BOX 4	NONE AVAILABLE
BOX 6	#160 (23% OPEN)
DEEP BOX 6	NONE AVAILABLE
BOX 8	#160 (23% OPEN)
DEEP BOX 8	NONE AVAILABLE

**\*\*IMPORTANT NOTE (A)\*\***  
MULTI-BOX CEILINGS MAY COMPRISE ANY BOX AND DEEP BOX PANELS IN ANY ORDER/PATTERN DESIRED.

**\*\*IMPORTANT NOTE (B)\*\***  
PLEASE SPECIFY PATTERN REPEAT AND PATTERN START POINT IN EACH AREA DESIRED.

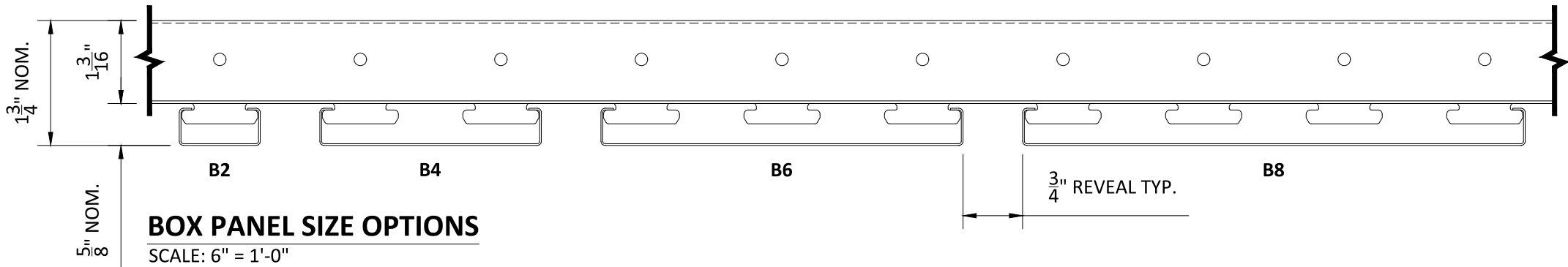

**BOX PANEL SIZE OPTIONS**  
SCALE: 6" = 1'-0"

TABLE 2 - MATERIAL THICKNESS OPTIONS				
PANEL SIZE	.020"	.025"	.032"	.040"
BOX 2	X	X		
DEEP BOX 2	X	X		
BOX 4	X	X	X	
DEEP BOX 4	X	X	X	X
BOX 6	X	X	X	X
DEEP BOX 6	X	X	X	X
BOX 8			X	X
DEEP BOX 8			X	X

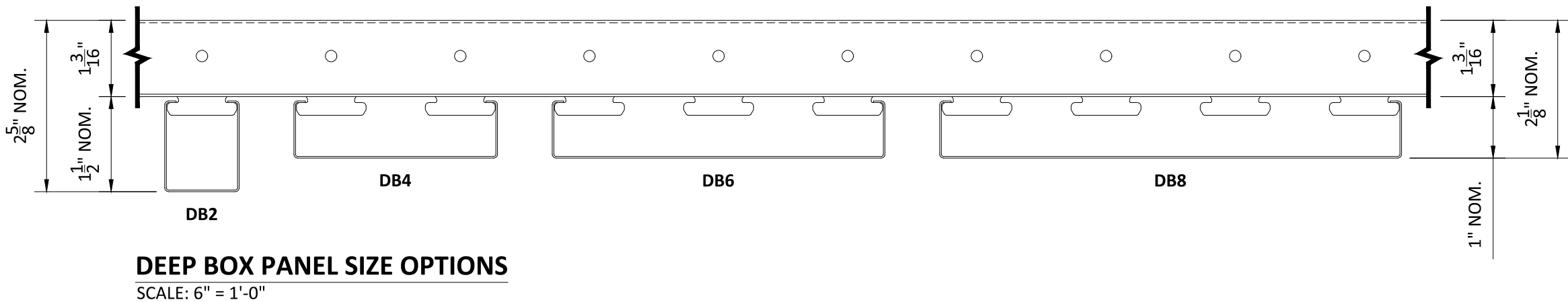

**DEEP BOX PANEL SIZE OPTIONS**  
SCALE: 6" = 1'-0"

**SPECIFICATIONS**  
(unless noted otherwise)

MATERIAL: SEE TABLE 2 ABOVE | .040" ALUMINUM UNIVERSAL CARRIER  
FINISH: PAINT | POWDER COAT | DECORATED WOOD FINISH | WOOD VENEER | LUXACOTE  
PERFORATION: SEE TABLE 1 ABOVE

**PANEL SPECIFICATIONS**

PROJECT: MULTI-BOX CONTINUOUS PRODUCT SPECIFICATIONS  
DRAWING NUMBER: MULTI-BOX CONT-A1.1  
SCALE: AS SHOWN  
DRAWN BY: HDA ENGINEERING  
DATE: 8/15/16

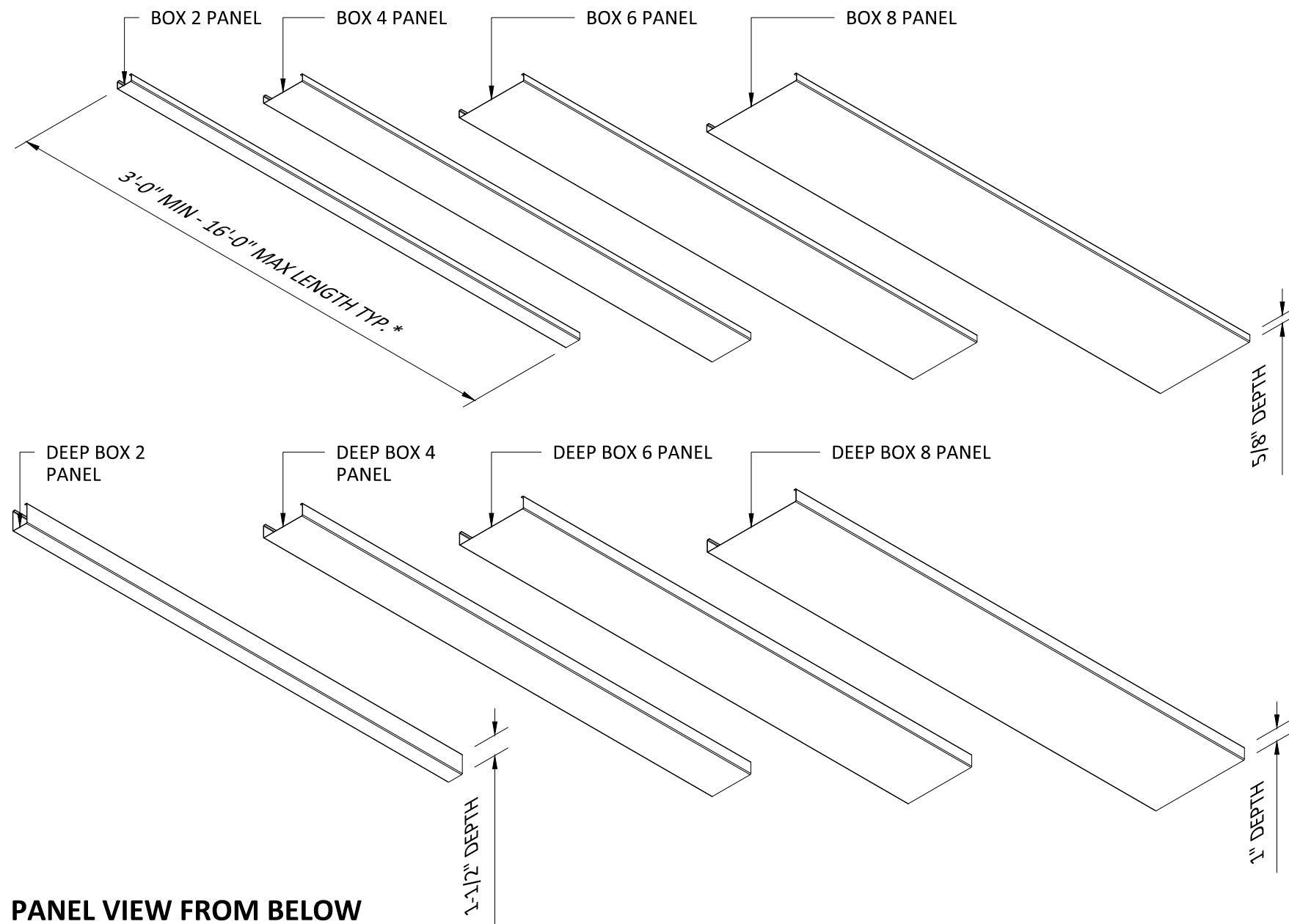

**\*\*IMPORTANT NOTE (A)\*\***  
MULTI-BOX CEILINGS MAY  
COMPRISE ANY BOX AND  
DEEP BOX PANELS IN ANY  
ORDER/PATTERN DESIRED.

**\*\*IMPORTANT NOTE (B)\*\***  
PLEASE SPECIFY PATTERN  
REPEAT AND PATTERN START  
POINT IN EACH AREA DESIRED.

**PANEL FINISHES**

PAINTED & POWDER COATED

LUXACOTE

DECORATED WOOD FINISH (POWDER COATED)

WOOD VENEER

\*10'-0" MAX RECOMMENDED PANEL LENGTH WITHOUT FINGER-JOINTING OF VENEER

16'-0" MAX RECOMMENDED PANEL LENGTH WITH FINGER-JOINTING OF VENEER



**SPECIFICATIONS**

(unless noted otherwise)

MATERIAL: SEE DETAIL A1.1 THIS SET FOR MULTI-BOX PANELS | .040" ALUMINUM

UNIVERSAL CARRIER

FINISH: PAINT | POWDER COAT | DECORATED WOOD FINISH | WOOD VENEER |

LUXACOTE

PERFORATION: SEE DETAIL A1.1 THIS SET

**PANEL FINISHES**

PROJECT: MULTI-BOX CONTINUOUS PRODUCT SPECIFICATIONS

DRAWING NUMBER: MULTI-BOX CONT-A1.2

SCALE: AS SHOWN

DRAWN BY: HDA ENGINEERING

DATE: 8/15/16

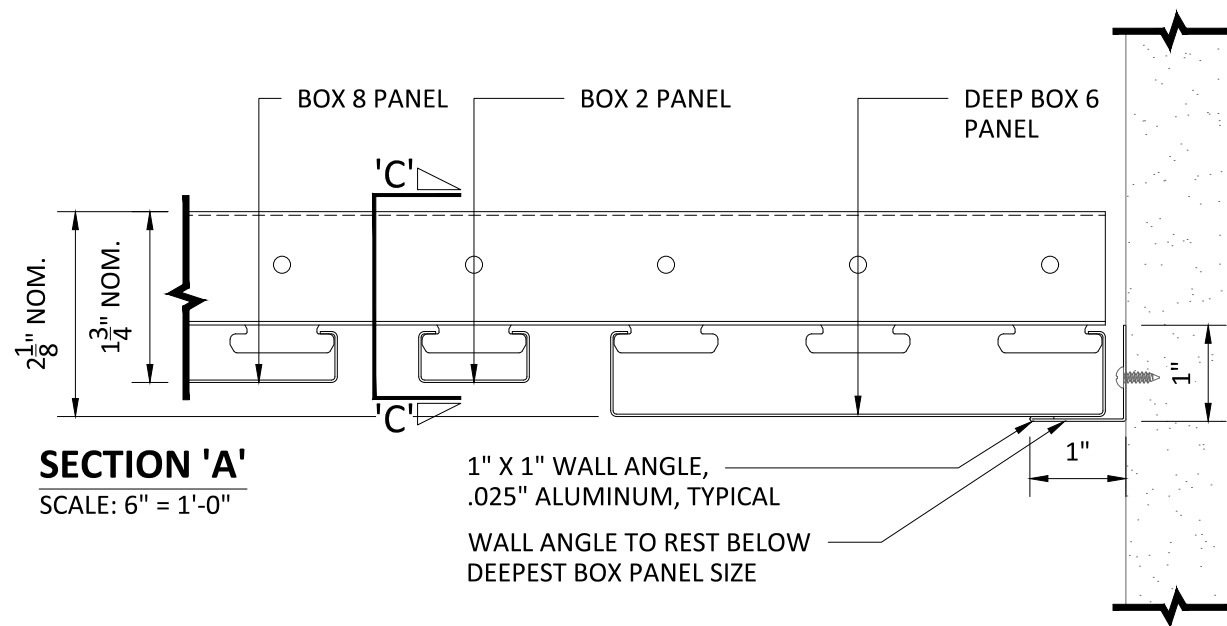

**SECTION 'A'**  
SCALE: 6" = 1'-0"

1" X 1" WALL ANGLE,  
.025" ALUMINUM, TYPICAL  
WALL ANGLE TO REST BELOW  
DEEPEST BOX PANEL SIZE

**\*\*IMPORTANT NOTE (A)\*\***  
MULTI-BOX CEILINGS MAY COMPRISE  
ANY BOX AND DEEP BOX PANELS IN  
ANY ORDER/PATTERN DESIRED.

**\*\*IMPORTANT NOTE (B)\*\***  
PLEASE SPECIFY PATTERN  
REPEAT AND PATTERN START  
POINT IN EACH AREA DESIRED.

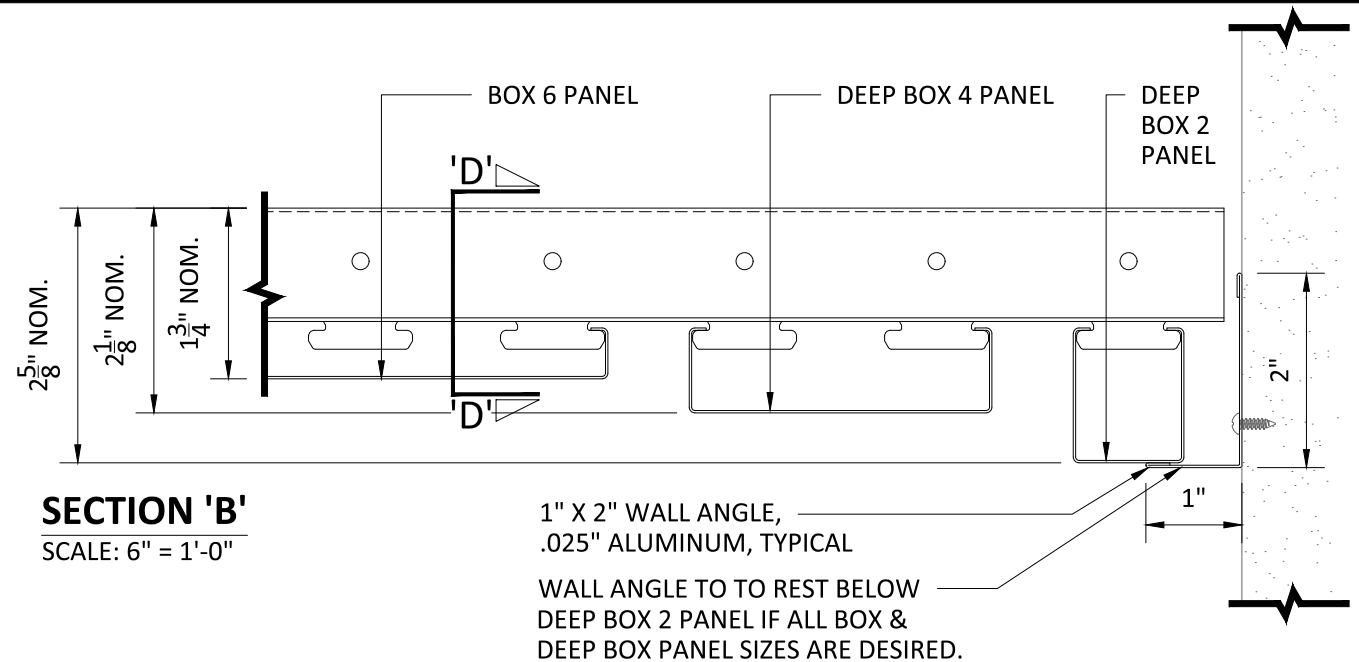

**SECTION 'B'**  
SCALE: 6" = 1'-0"

1" X 2" WALL ANGLE,  
.025" ALUMINUM, TYPICAL  
WALL ANGLE TO TO REST BELOW  
DEEP BOX 2 PANEL IF ALL BOX &  
DEEP BOX PANEL SIZES ARE DESIRED.

**\*\*IMPORTANT NOTE (A)\*\***  
MULTI-BOX CEILINGS MAY COMPRISE  
ANY BOX AND DEEP BOX PANELS IN  
ANY ORDER/PATTERN DESIRED.

**\*\*IMPORTANT NOTE (B)\*\***  
PLEASE SPECIFY PATTERN  
REPEAT AND PATTERN START  
POINT IN EACH AREA DESIRED.

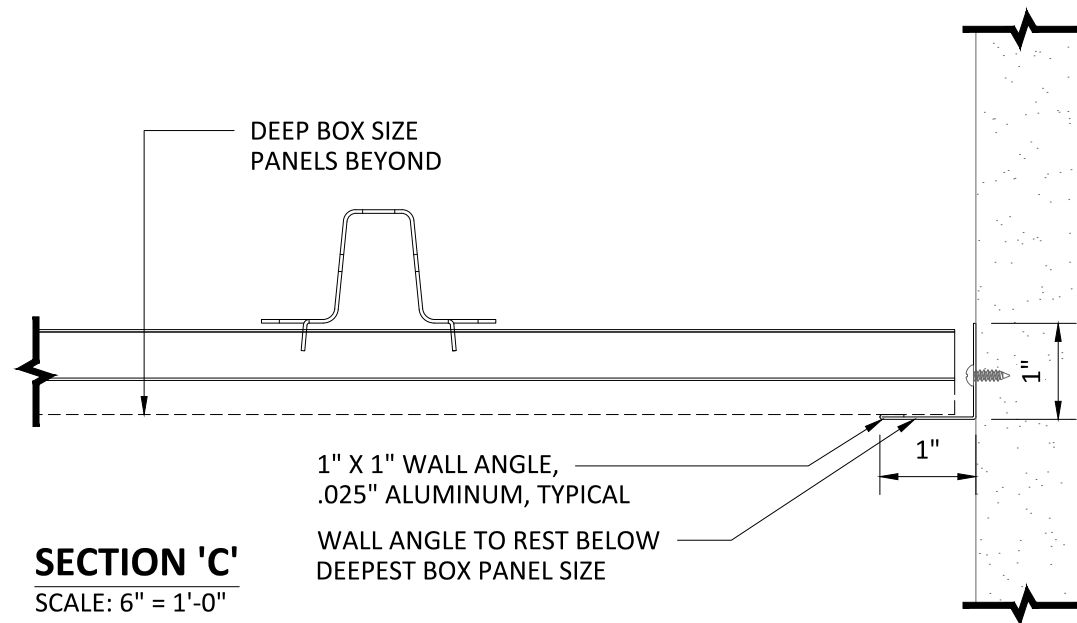

**SECTION 'C'**  
SCALE: 6" = 1'-0"

1" X 1" WALL ANGLE,  
.025" ALUMINUM, TYPICAL  
WALL ANGLE TO REST BELOW  
DEEPEST BOX PANEL SIZE

**\*\*IMPORTANT NOTE (A)\*\***  
MULTI-BOX CEILINGS MAY COMPRISE  
ANY BOX AND DEEP BOX PANELS IN  
ANY ORDER/PATTERN DESIRED.

**\*\*IMPORTANT NOTE (B)\*\***  
PLEASE SPECIFY PATTERN  
REPEAT AND PATTERN START  
POINT IN EACH AREA DESIRED.

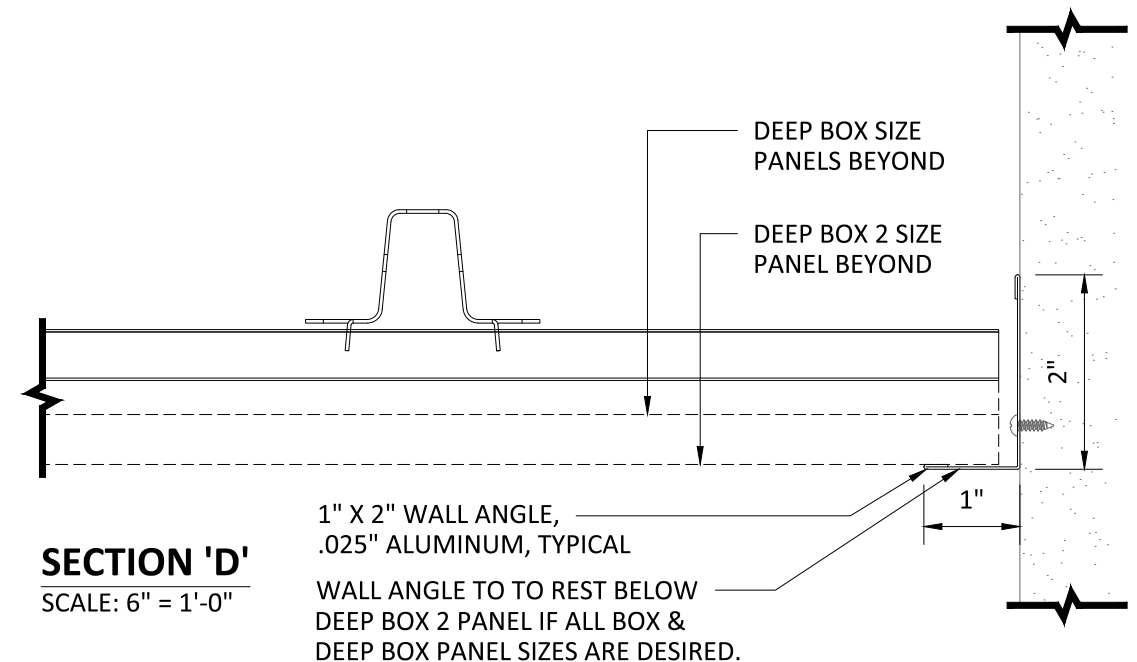

**SECTION 'D'**  
SCALE: 6" = 1'-0"

1" X 2" WALL ANGLE,  
.025" ALUMINUM, TYPICAL  
WALL ANGLE TO TO REST BELOW  
DEEP BOX 2 PANEL IF ALL BOX &  
DEEP BOX PANEL SIZES ARE DESIRED.

**\*\*IMPORTANT NOTE (A)\*\***  
MULTI-BOX CEILINGS MAY COMPRISE  
ANY BOX AND DEEP BOX PANELS IN  
ANY ORDER/PATTERN DESIRED.

**\*\*IMPORTANT NOTE (B)\*\***  
PLEASE SPECIFY PATTERN  
REPEAT AND PATTERN START  
POINT IN EACH AREA DESIRED.

## INTERIOR INSTALLATION

## SPECIFICATIONS

(unless noted otherwise)

MATERIAL: SEE DETAIL A1.1 THIS SET FOR MULTI-BOX PANELS | .040" ALUMINUM  
UNIVERSAL CARRIER  
FINISH: PAINT | POWDER COAT | DECORATED WOOD FINISH | WOOD VENEER |  
LUXACOTE  
PERFORATION: SEE DETAIL A1.1 THIS SET

## WALL ANGLE TRIM SPECIFICATIONS

PROJECT: MULTI-BOX CONTINUOUS PRODUCT SPECIFICATIONS  
DRAWING NUMBER: MULTI-BOX CONT-A1.3  
SCALE: AS SHOWN  
DRAWN BY: HDA ENGINEERING  
DATE: 8/15/16



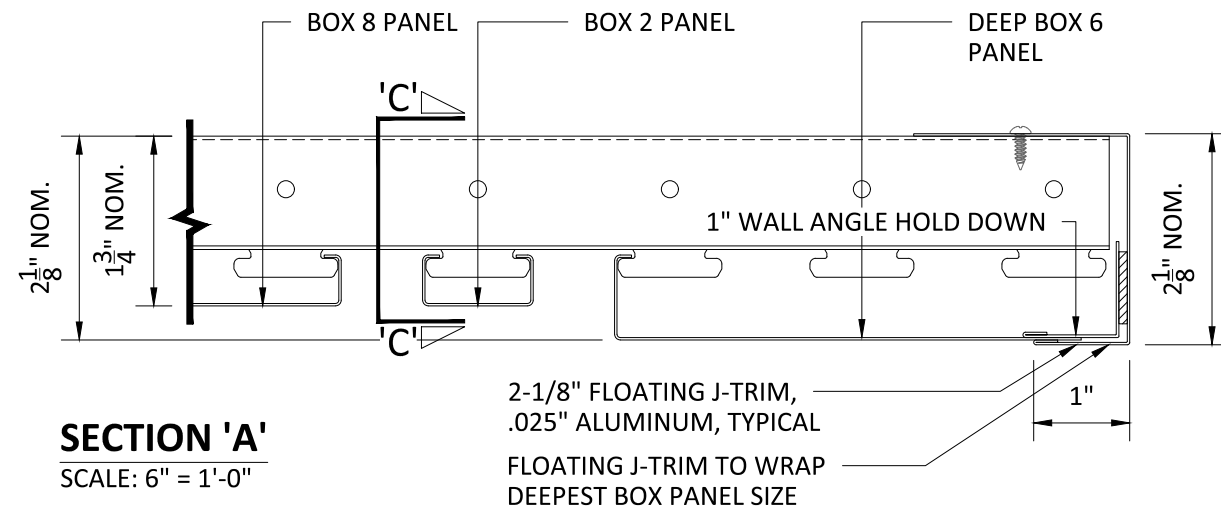

**SECTION 'A'**  
SCALE: 6" = 1'-0"

**\*\*IMPORTANT NOTE (A)\*\***  
MULTI-BOX CEILINGS MAY COMPRISE ANY BOX AND DEEP BOX PANELS IN ANY ORDER/PATTERN DESIRED.

**\*\*IMPORTANT NOTE (B)\*\***  
PLEASE SPECIFY PATTERN REPEAT AND PATTERN START POINT IN EACH AREA DESIRED.

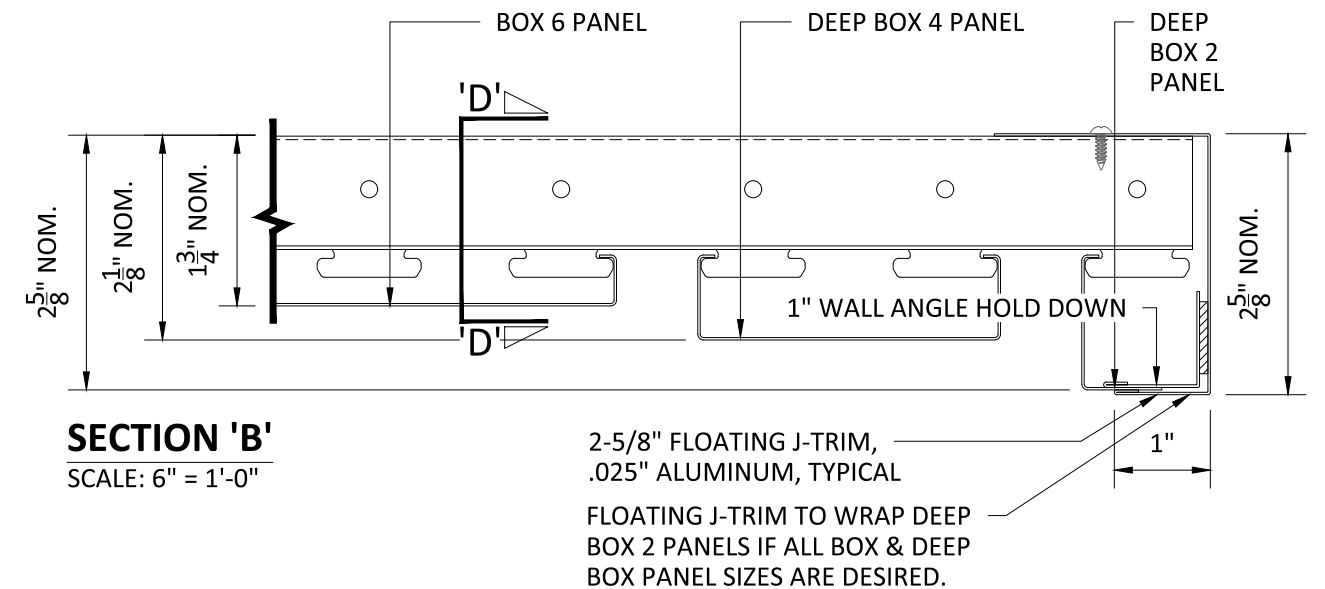

**SECTION 'B'**  
SCALE: 6" = 1'-0"

**\*\*IMPORTANT NOTE (A)\*\***  
MULTI-BOX CEILINGS MAY COMPRISE ANY BOX AND DEEP BOX PANELS IN ANY ORDER/PATTERN DESIRED.

**\*\*IMPORTANT NOTE (B)\*\***  
PLEASE SPECIFY PATTERN REPEAT AND PATTERN START POINT IN EACH AREA DESIRED.

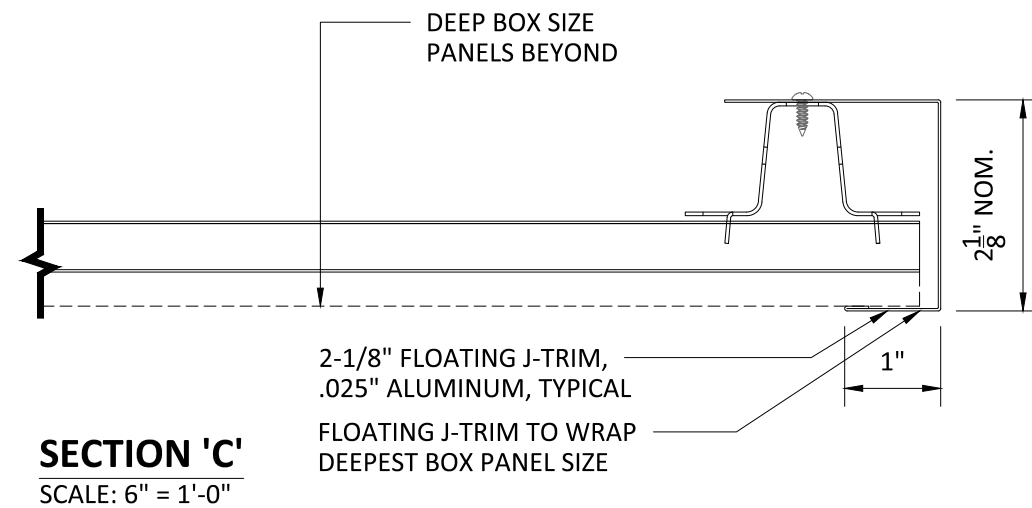

**SECTION 'C'**  
SCALE: 6" = 1'-0"

**\*\*IMPORTANT NOTE (A)\*\***  
MULTI-BOX CEILINGS MAY COMPRISE ANY BOX AND DEEP BOX PANELS IN ANY ORDER/PATTERN DESIRED.

**\*\*IMPORTANT NOTE (B)\*\***  
PLEASE SPECIFY PATTERN REPEAT AND PATTERN START POINT IN EACH AREA DESIRED.

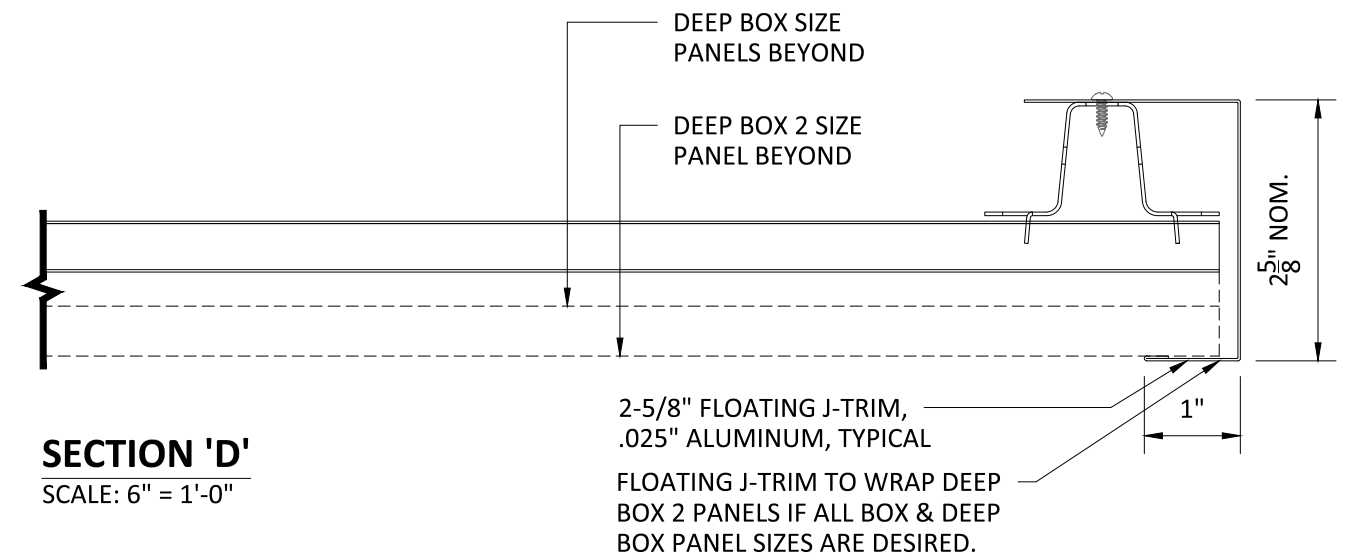

**SECTION 'D'**  
SCALE: 6" = 1'-0"

**\*\*IMPORTANT NOTE (A)\*\***  
MULTI-BOX CEILINGS MAY COMPRISE ANY BOX AND DEEP BOX PANELS IN ANY ORDER/PATTERN DESIRED.

**\*\*IMPORTANT NOTE (B)\*\***  
PLEASE SPECIFY PATTERN REPEAT AND PATTERN START POINT IN EACH AREA DESIRED.

## INTERIOR INSTALLATION

### SPECIFICATIONS

(unless noted otherwise)

MATERIAL: SEE DETAIL A1.1 THIS SET FOR MULTI-BOX PANELS | .040" ALUMINUM  
UNIVERSAL CARRIER  
FINISH: PAINT | POWDER COAT | DECORATED WOOD FINISH | WOOD VENEER | LUXACOTE  
PERFORATION: SEE DETAIL A1.1 THIS SET

### FLOATING J-TRIM SPECIFICATIONS

PROJECT: MULTI-BOX CONTINUOUS PRODUCT SPECIFICATIONS  
DRAWING NUMBER: MULTI-BOX CONT-A1.4  
SCALE: AS SHOWN  
DRAWN BY: HDA ENGINEERING  
DATE: 8/15/16

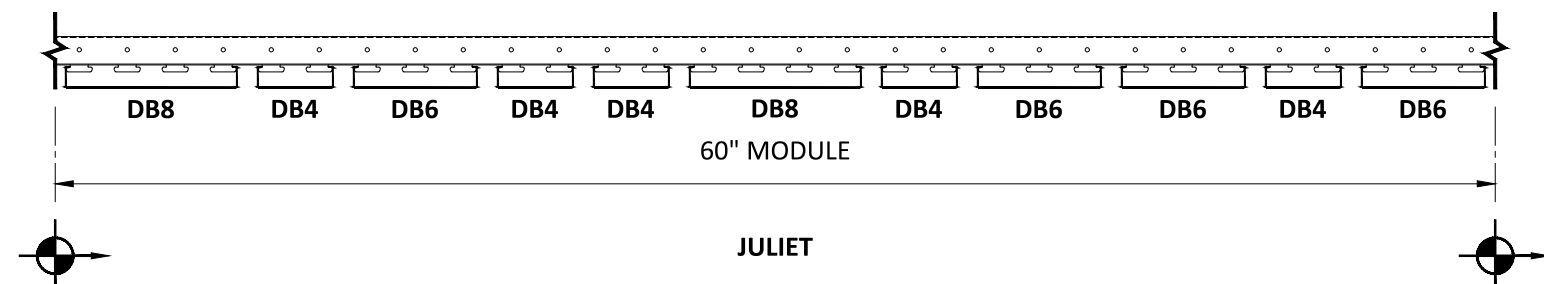
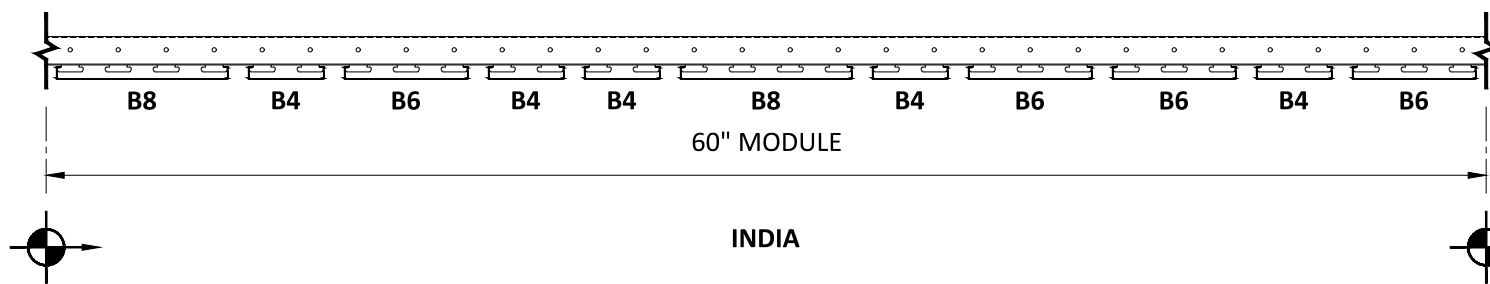
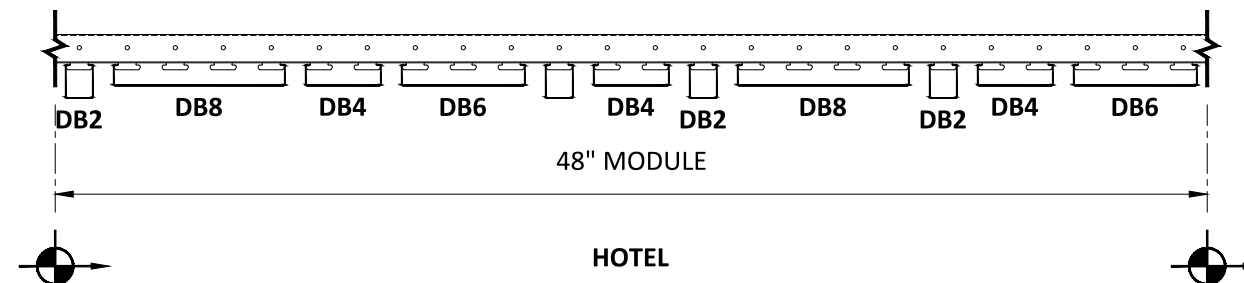
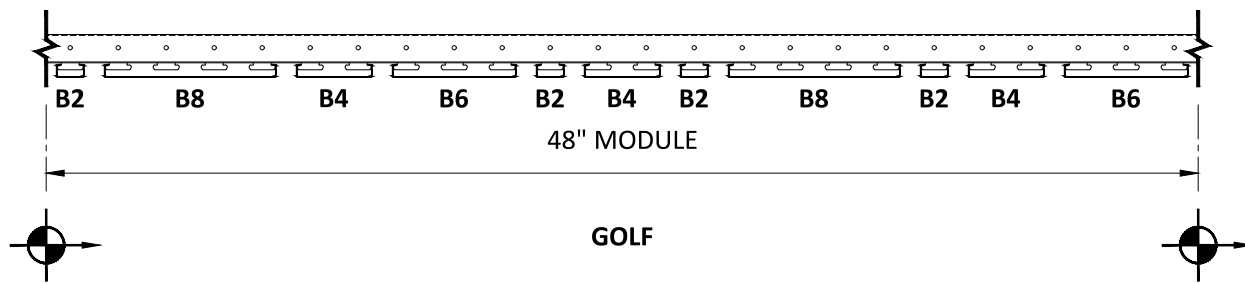
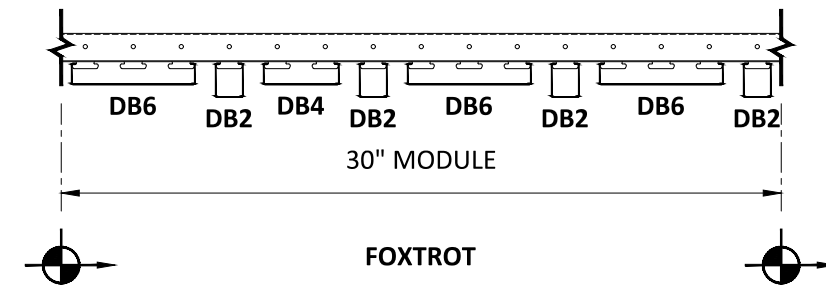
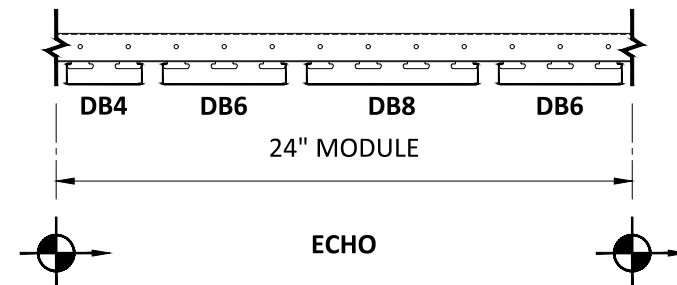
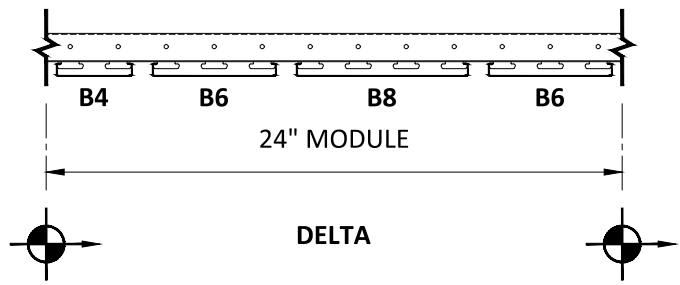
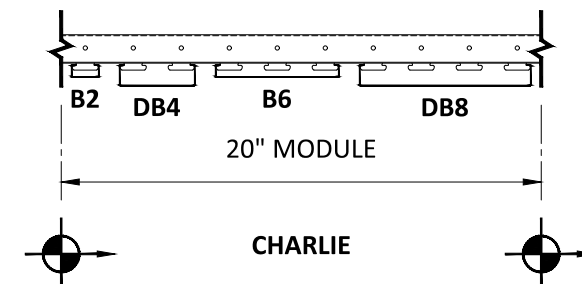
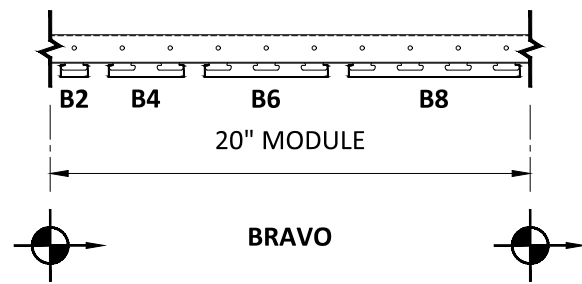
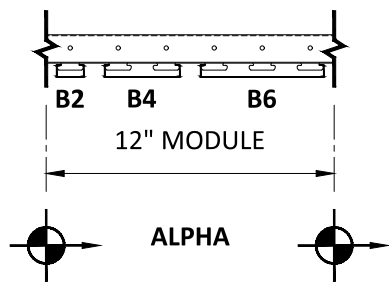

#### SPECIFICATIONS

(unless noted otherwise)

MATERIAL: SEE DETAIL A1.1 THIS SET FOR MULTI-BOX PANELS | .040" ALUMINUM

UNIVERSAL CARRIER

FINISH: PAINT | POWDER COAT | DECORATED WOOD FINISH | WOOD VENEER |

LUXACOTE

PERFORATION: SEE DETAIL A1.1 THIS SET

#### MULTI-BOX CONTINUOUS PATTERNS

PROJECT: MULTI-BOX CONTINUOUS PRODUCT SPECIFICATIONS

DRAWING NUMBER: MULTI-BOX CONT-A1.5

SCALE: 1-1/2" = 1'-0"

DRAWN BY: HDA ENGINEERING

DATE: 8/15/16