

SECTION 'A'
SCALE: 6" = 1'-0"

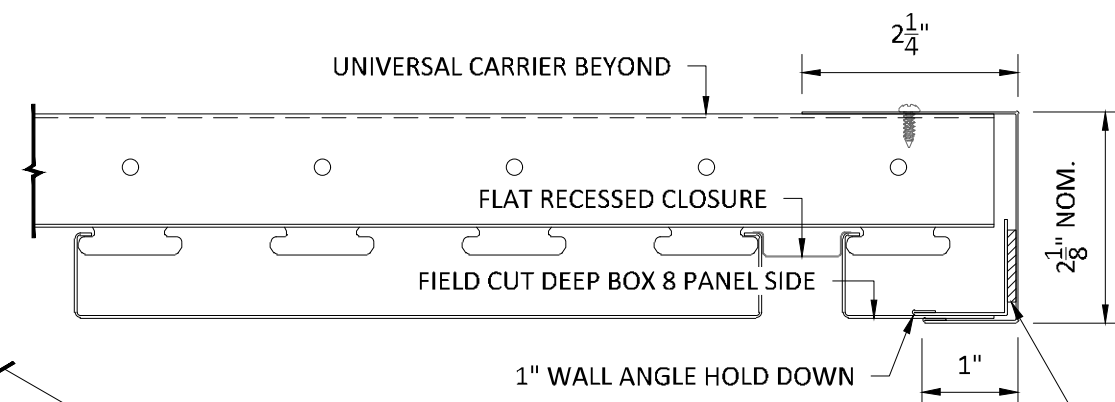

SECTION 'B'
SCALE: 6" = 1'-0"

DOUBLE-SIDED ADHESIVE
TO SECURE 1" WALL
ANGLE OR USE POP-RIVET

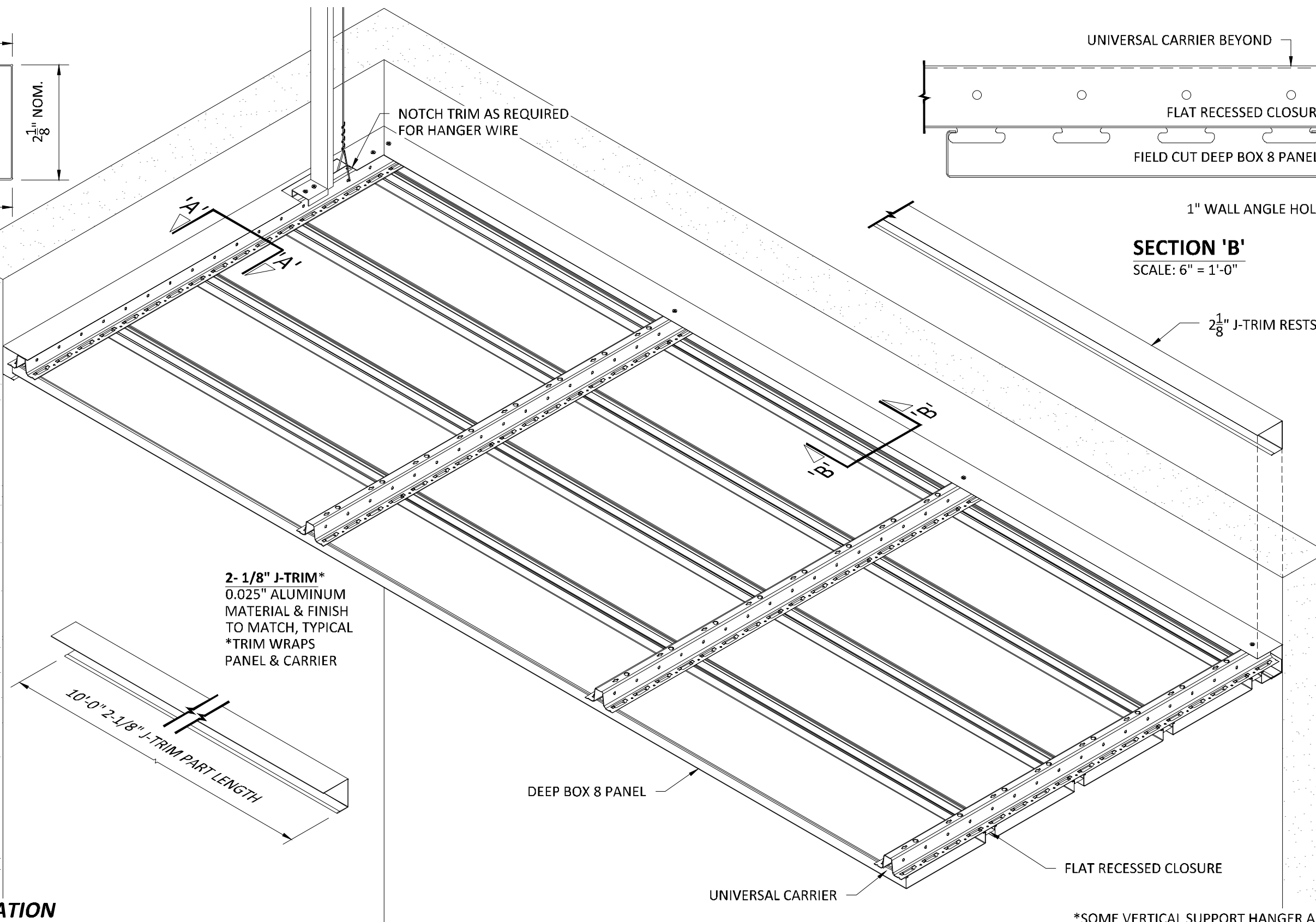

2- 1/8" J-TRIM*
0.025" ALUMINUM
MATERIAL & FINISH
TO MATCH, TYPICAL
*TRIM WRAPS
PANEL & CARRIER

10'-0" 2-1/8" J-TRIM PART LENGTH

DEEP BOX 8 PANEL

UNIVERSAL CARRIER

FLAT RECESSED CLOSURE

2 1/8" J-TRIM RESTS AGAINST WALL

EXTERIOR INSTALLATION

*SOME VERTICAL SUPPORT HANGER AND WIRE OMITTED FOR CLARITY

HunterDouglas
Architectural

5015 Oakbrook Parkway, Suite 100
Norcross, GA 30093
T 800.366.4327
F 770.806.0214
HDarchitectural.com

All rights reserved. This drawing is the property of Hunter Douglas. It may not be copied or multiplied, neither wholly nor partly. It may not be submitted for perusal to third parties.

SPECIFICATIONS
(unless noted otherwise)

MATERIAL: .032" | .040" ALUMINUM DEEP BOX 8 PANEL | .040" ALUMINUM
UNIVERSAL CARRIER
FINISH: PAINT | POWDER COAT | DECORATED WOOD FINISH | LUXACOTE
PERFORATION: NOT AVAILABLE

2 1/8" FLOATING 'J' TRIM

PROJECT: LINEAR EXTERIOR DEEP BOX 8 PRODUCT SPECIFICATIONS
DRAWING NUMBER: DEEP BOX8-B1.8
SCALE: AS SHOWN
DRAWN BY: HDA ENGINEERING
DATE: 12/5/16